

LED down light instruction manual

■ Attention

1. Before using this product, please know the electrical, dimension and other parameters of the product to meet your demand.
2. Before installing this fixture or doing any maintenance, make sure to turn off the power supply at the circuit breaker or fuse box.
3. Make sure that there is a at least 75mm vent around the product. And the use of this lamp cannot violate any rules of fire protection.
4. Do not install such lamps on ceilings that are easily damaged and deformed.
5. This product is a special indoor lamp for common environment and can't be used in humid places and outdoors.
6. Consult a qualified electrician to ensure correct branch circuit conductor.

■ Mounting Instruction

1. Make a suitable mounting hole on the ceiling (please refer to the cut-size table for details)
2. Remove the cover as figure 1;
3. Connect the mains power to the power drive input terminals, and place the power drive on the ceiling, as Figure 2 and Figure 3;
4. After the lamp body is embedded in the ceiling, adjust the screws in a clockwise direction with an electric screwdriver until it is tight. , as Figure 4;
5. Clip the cover into the grille cover, as Figure 5;
6. Finished.

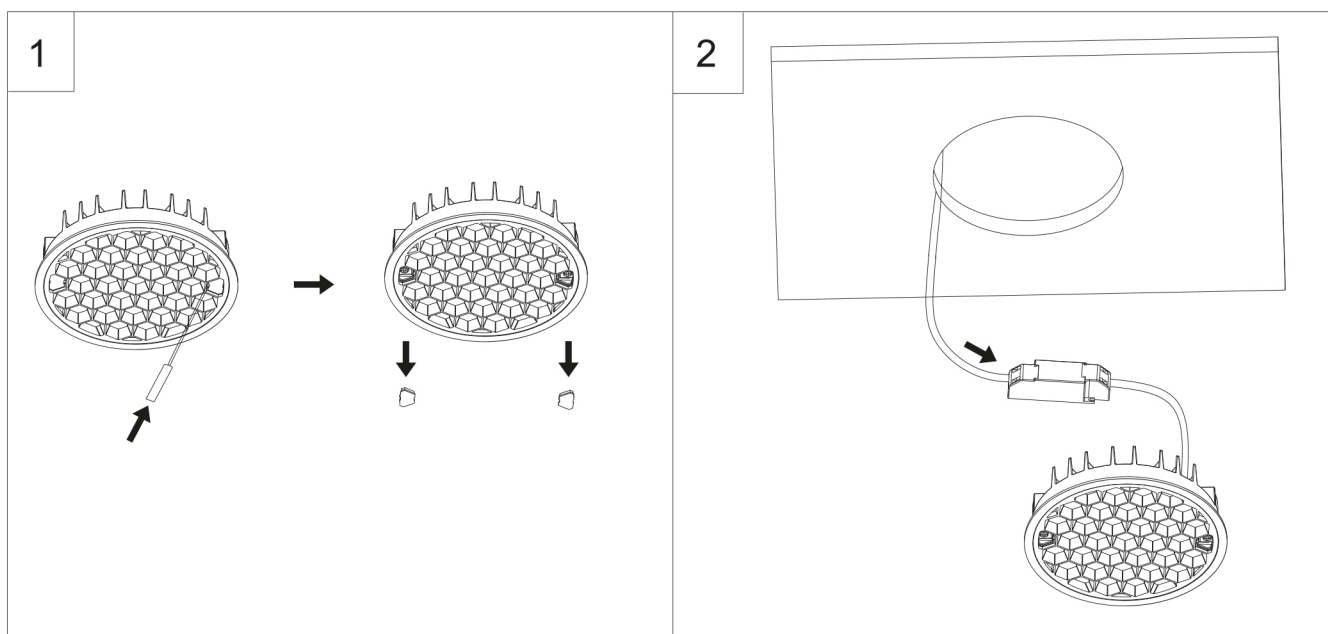

3

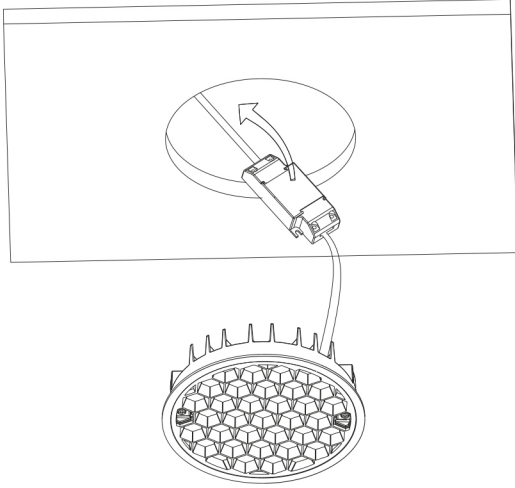

4

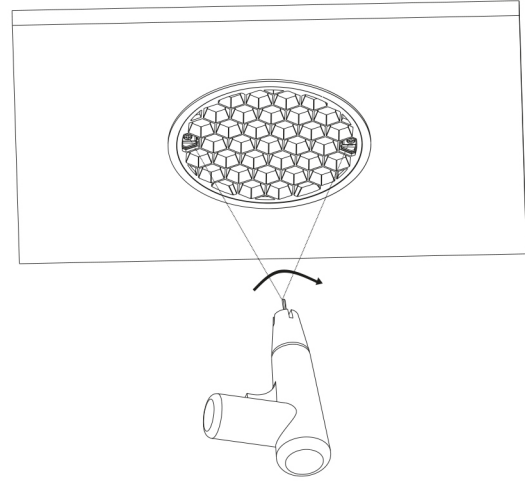

5

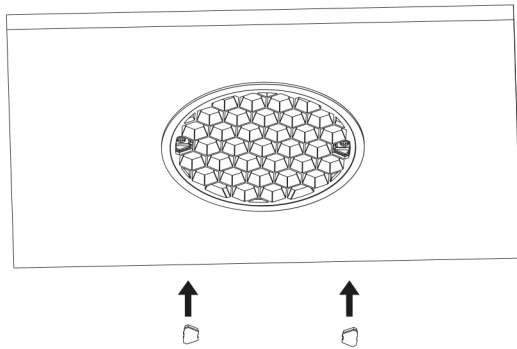

6

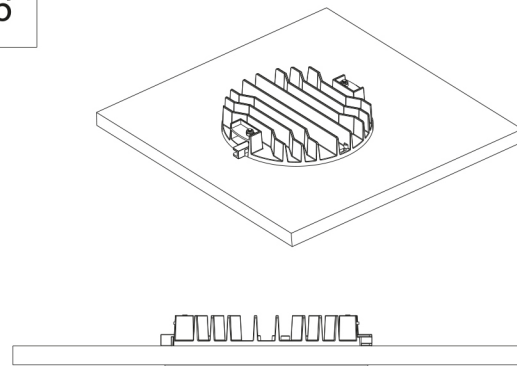

The cut-size table

Product dimension	Cut size	Ceiling thickness
6inch	$\phi 150 \pm 1\text{mm}$	2mm-24mm
8inch	$\phi 200 \pm 1\text{mm}$	2mm-24mm